

EVoline[®] R-Dock



Contemporary and modern for all workspaces.

EVoline[®] R-Dock

EVoline R-Dock can be installed into any right-angled corner.

With its flat back and angled front fascia, it is comfortable to use. Freely configurable.

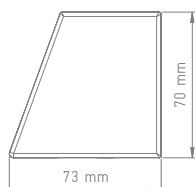
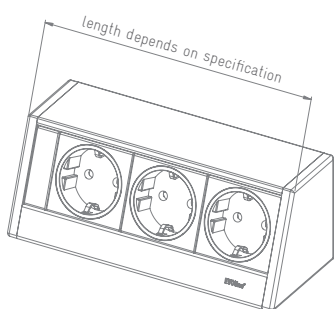

Examples of power supply options:

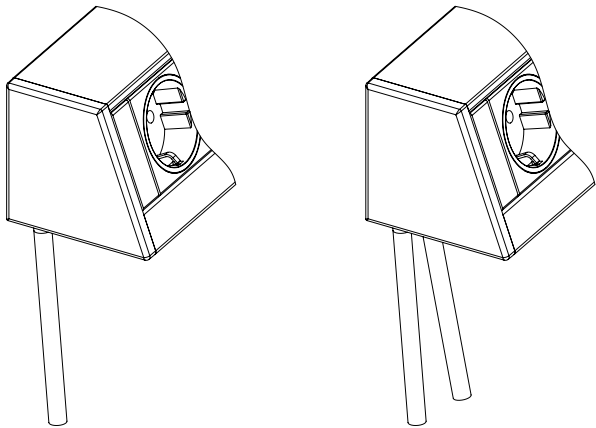

Fixed Power Supply Cable through the bottom of the profile

Available with several country specific plugs, with wire end ferrules, Wieland GST 18i3, or WAGO WINSTA Connector

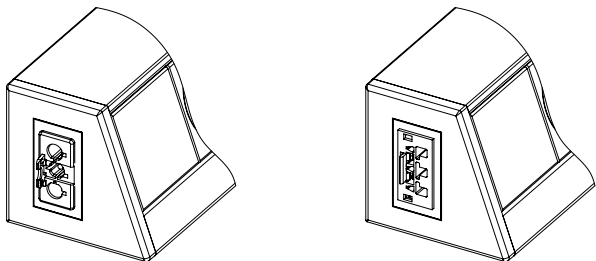

End cap with power input or output connector, depending on the surface thickness (max. 18 mm)

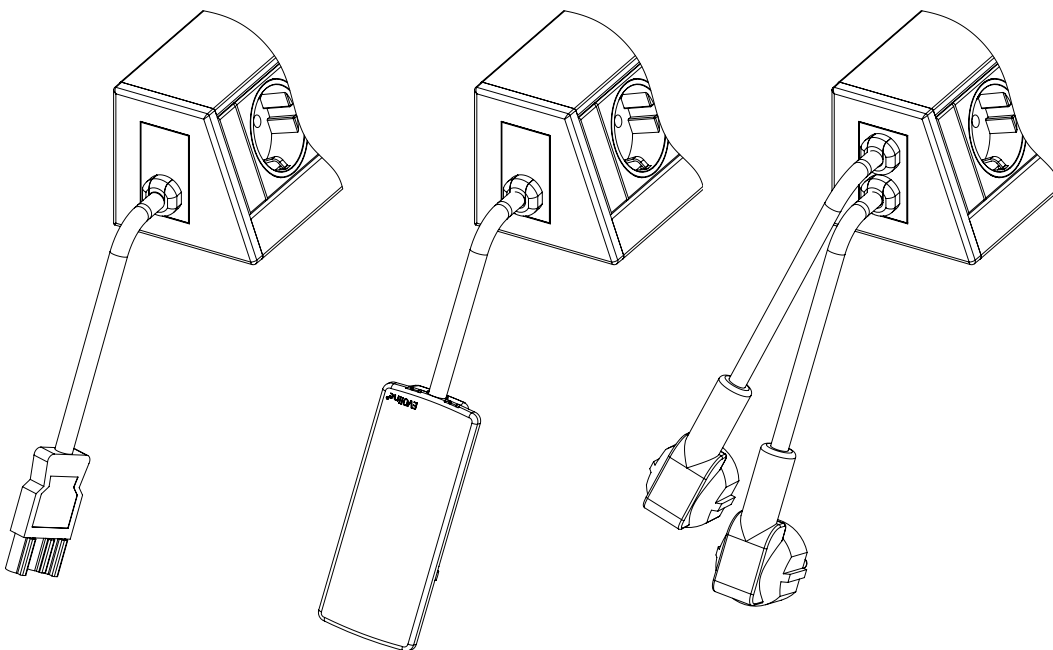



End cap with fixed power supply cable

Available with several country specific plugs, EVOLine Plug, wire end ferrules, Wieland GST 18i3- or WAGO WINSTA Connector.

EVoline® R-Dock

Description	Picture	Specifications	Order Number
<p>EVoline R-Dock SMALL*</p> <p>Aluminium housing, 3× sockets, VDE-compliant, 0°, 16 A, contact-protected. Fixed supply cable 3.0 m with angled plug. Power supply cable entry on the left side in the bottom of the profile.</p>		<p>Silver anodised</p> <p>White powder-coated</p>	<p>1598 0000 1700</p> <p>1598 0000 8600</p>
<p>EVoline R-Dock DATA SMALL*</p> <p>Aluminium housing, 3× sockets, VDE-compliant, 0°, 16 A, contact-protected. Fixed supply cable 3.0 m with angled plug. Two modular couplings RJ45 to RJ45 CAT6 shielded, 1:1 interconnected. Power and data cable entry in the bottom of the profile.</p>		<p>Silver anodised</p> <p>White powder-coated</p>	<p>1598 0000 1800</p> <p>1598 0000 8700</p>

EVoline® R-Dock Individual

<p>Empty Housing EVoline R-Dock*</p> <p>Aluminium housing.</p> <p>Power supply cable entry through end cap or profile.</p>		<p>Silver anodised</p>	<p>9331 0620 0000</p>
<p>Empty Housing EVoline R-Dock*</p> <p>Aluminium housing.</p> <p>Power supply cable entry through end cap or profile.</p>		<p>White powder-coated End caps lacquered to match housing colour (if cable entry is through the profile)</p>	<p>9331 4340 0000</p>

* Delivery without mounting accessories.

Surface variants:



Silver
anodised



White
powder coated

To choose the fixing accessories, please see chapter „Accessories, Fixing“



Mounting Clamp



Mounting set for
desk installation

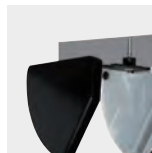

Mounting set for
cabinet
installation



Stainless steel
clamp



Stainless steel
pillar



Mounting Clamp,
white



Quicklock
Quicklock Pro

